

Inground 1-11

Cat. No. IG1-11



The Inground 1-11 is suitable for use with 50, 75 and 60 IRC watt lamps which have a range of beam angles from 8 to 45 degrees and is complete with its own 120 or 240 volt ac integral power supply and thermal overload. The AR1-11 lamp has very low glare output due to the dome covering the halogen capsule. The luminaire can be driven over at 10km/h max (6mph) with a maximum vehicle weight of 1500kg (3000lbs) or walked upon without being damaged. The fixture also has a 'Flush Fit' lens which stops water pooling and depositing dirt on the lens.

The Inground 1-11 is supplied with a mounting canister. The lamp can be directed (up to 20 degrees) without the need to remove the fitting from the canister due to the vandal-resistant four allen head screw fixing system which attaches the flange to the body of the luminaire.

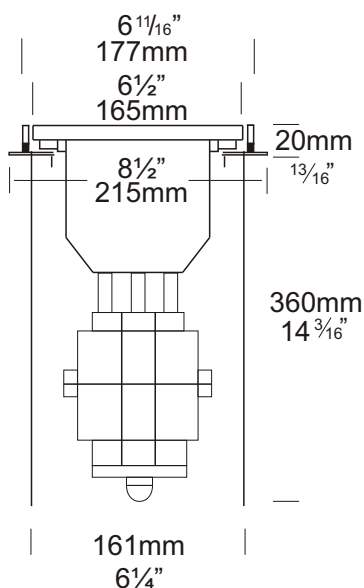

Ordering Information

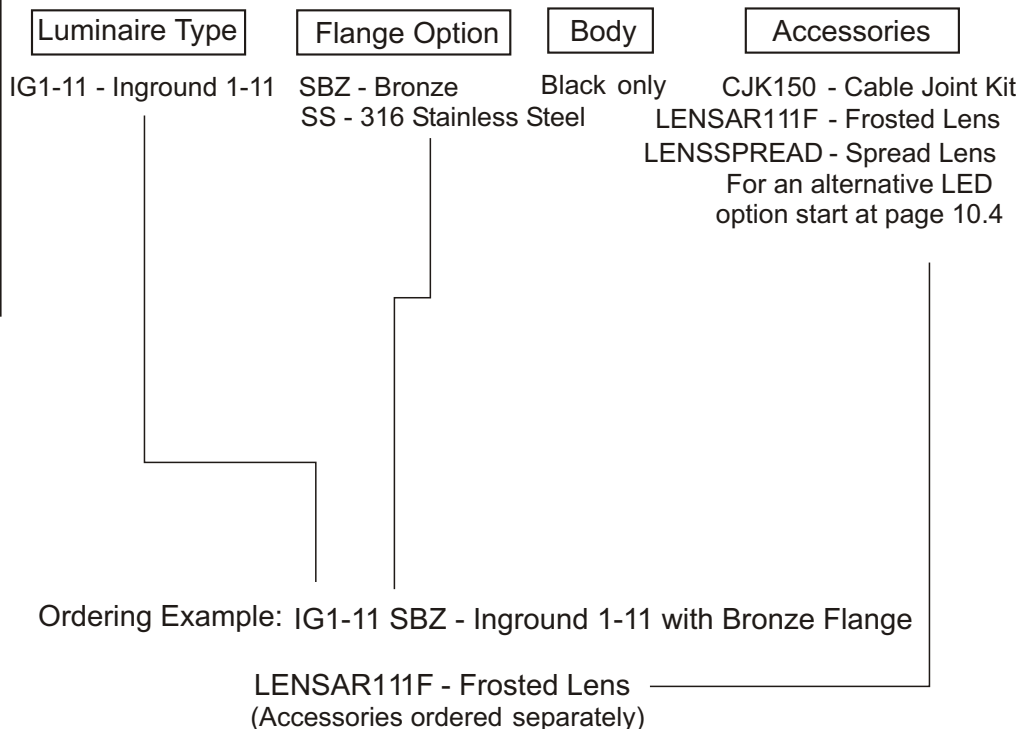

HUNZA™ PURE OUTDOOR LIGHTING

HUNZA FACTORY
130 Felton Mathew Ave
Glen Innes
Auckland 1072
New Zealand

Ph: 64-9-528 9471
Fax: 64-9-528 9361
hunza@hunza.co.nz
www.hunza.co.nz

INTERNATIONAL CONTACTS:
www.hunza.co.nz/contacts.php

Specifications may change without notice.
Manufactured in New Zealand.
© 2009 Hunza Holdings Ltd.

Ver 1.4

Luminaire Construction

Body

Cast from virgin high corrosion resistant CC401 low copper aluminium alloy, with chromate substrate and high UV resistant Black polyester powder coat.

Flanges

The flange is attached to the body by four 316 stainless steel allen head anti vandal screws and is available in either

Solid bronze - 170mm (6½") bar.

Solid 316 Stainless Steel - 170mm (6½") bar rod.

Mounting

The Inground 1-11 supplied with a mounting canister for casting in concrete. The fitting can be driven over or walked upon without damaging it. Maximum drive over speed 10 km/h (6 mph) and maximum vehicle weight 1500kg (3300lbs).

Features

Lens:

12mm (½") thick 'Flush Fit' clear tempered shatter resistant glass.

Life Time Warranty

Beam Angles:

8°, 24° and 45°

Gasket:

Silicone, iron impregnated 220°C (428°F).

Lamp Holder:

GU53: Lamp cradle can be rotated 360° and angled up to 20°.

Accessories:

Cable Joint Kit (Cat. CJK150).

Frosted Lens (Cat. LENSAR111F).

Linear Spread Lens (Cat. LENS SPREAD).

Standards

IP66



UL1598

Luminaire Weight

4.8kgs (10lbs 8oz)

Power Supply

HUNZA™ built in transformer.
Input: voltage 240 volt ac 50Hz.

USA and Canada:

Input voltage: 120 volt ac 60 Hz.

Luminaire: supplied with

GU53 - 50 halogen or 60 watt IRC lamp max.

LED - Refer sheet no. 10.4

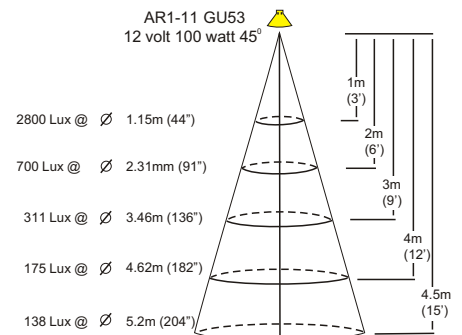
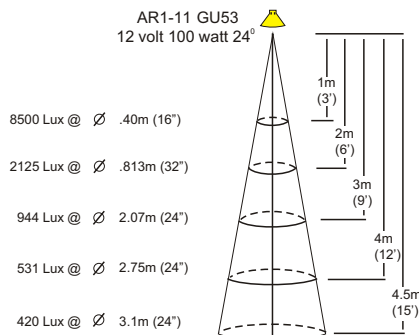
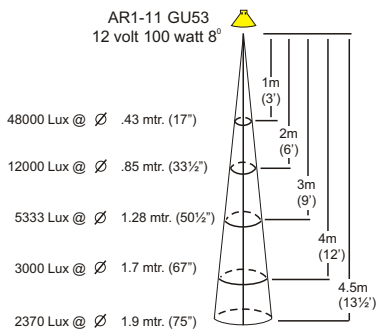

HUNZA™ PURE
OUTDOOR
LIGHTING

HUNZA FACTORY
130 Felton Mathew Ave
Glen Innes
Auckland 1072
New Zealand

Ph: 64-9-528 9471
Fax: 64-9-528 9361
hunza@hunza.co.nz
www.hunza.co.nz

INTERNATIONAL CONTACTS:
www.hunza.co.nz/contacts.php

Specifications may change without notice.
Manufactured in New Zealand.

© 2009 Hunza Holdings Ltd.

Ver 1.4